

 6x	 10x		 2 ajtós szekrény, válaszfallal  Kód.: 222
Csavarhossz=13mm  12x	 12x		Súly: 65 kg

1.

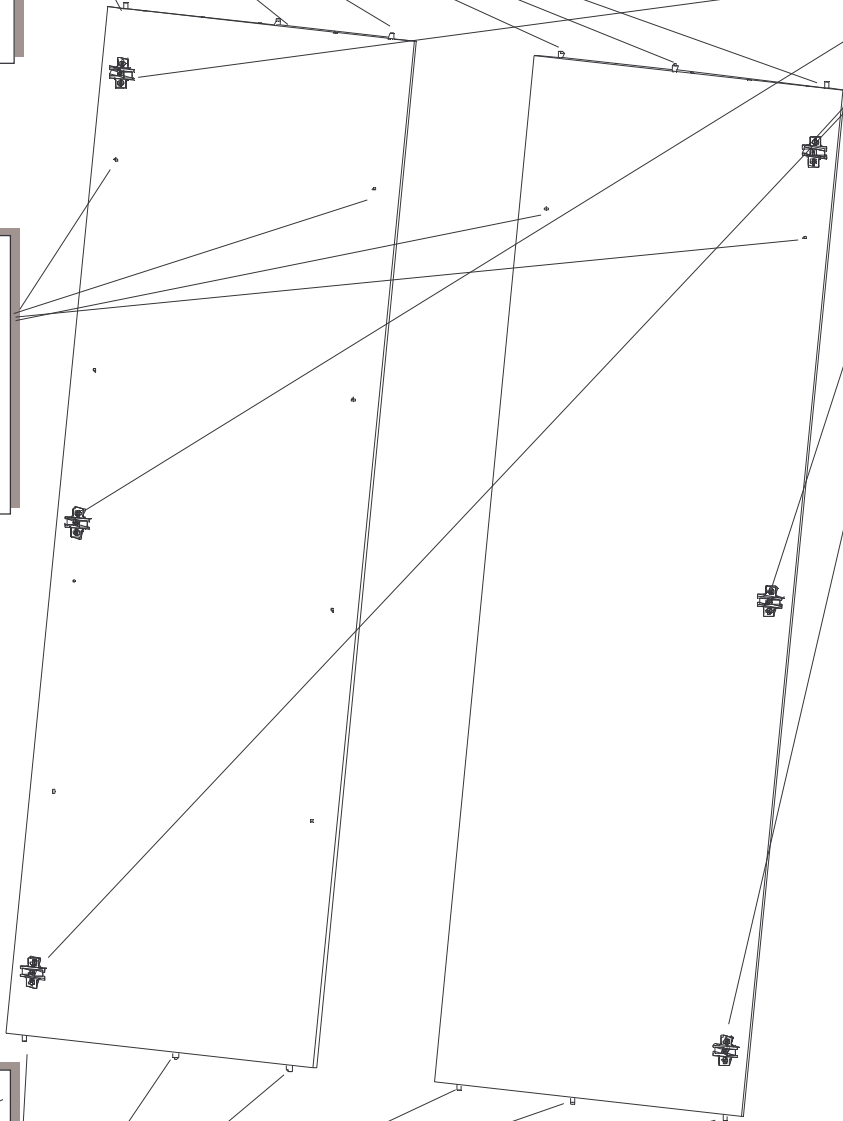

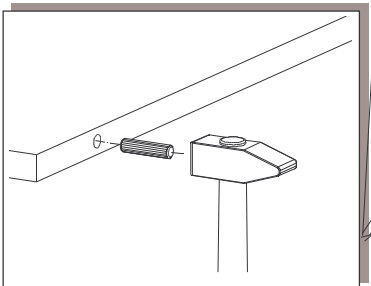
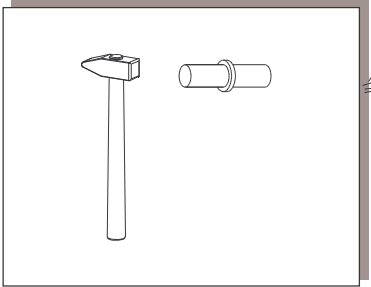
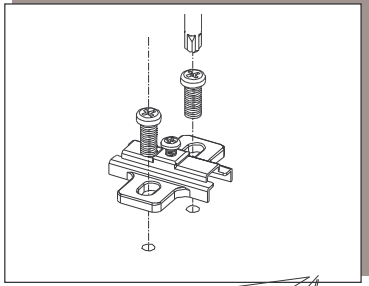
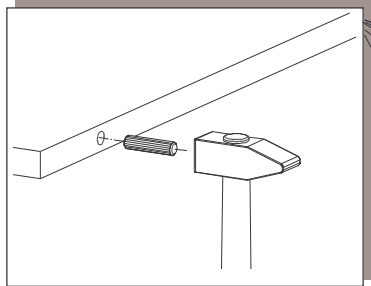
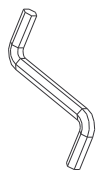

1x

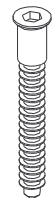

4x

2 ajtós szekrény
válaszfalal

Kód: 222

2.

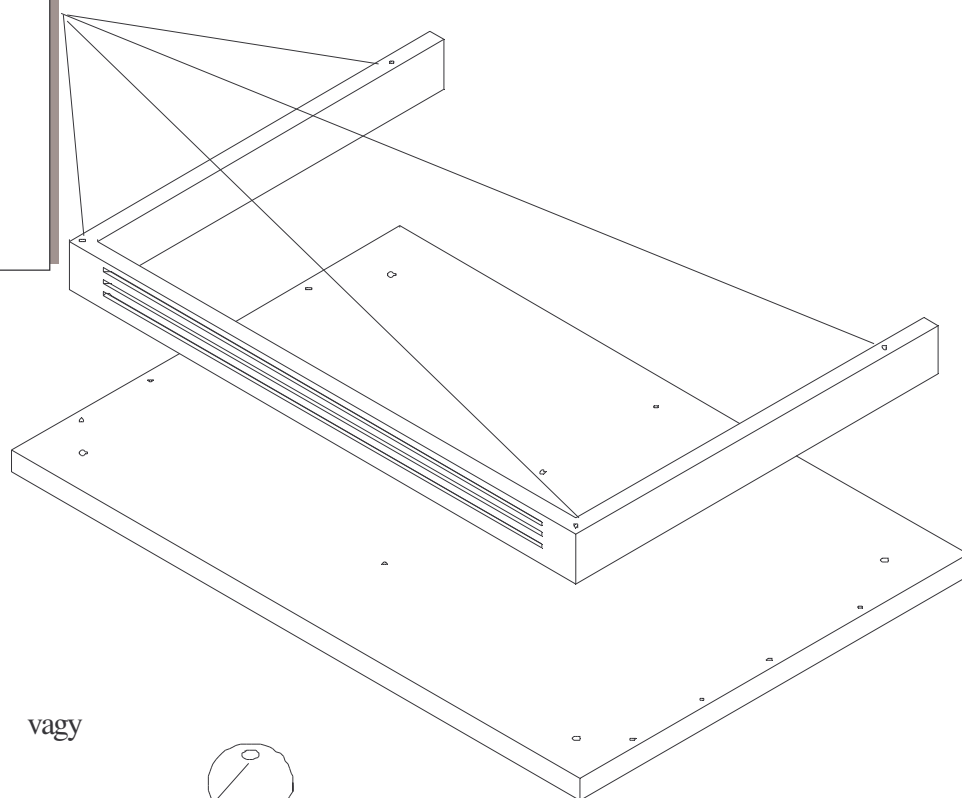
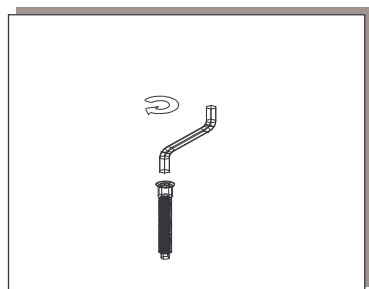

vagy

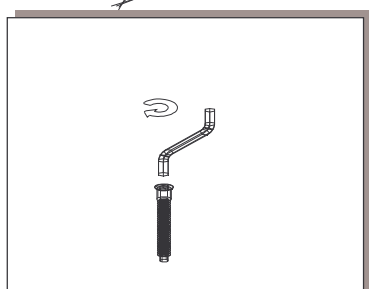
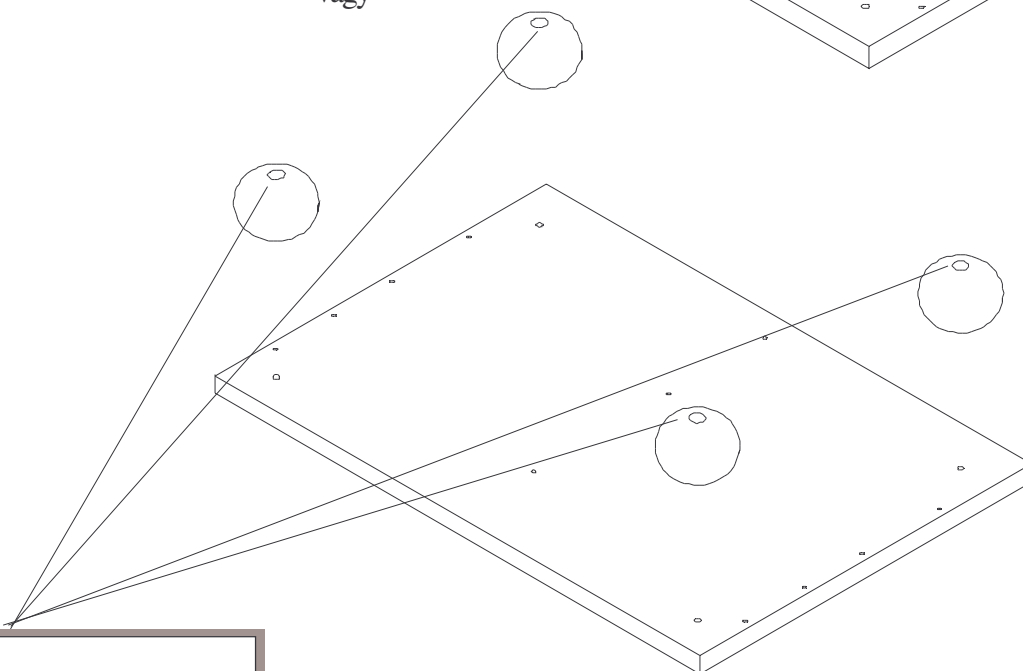

A szekrény lábuzatát igénytől függően
szerelvényezheti fel, az ábrán látható két
mód közül.

2 ajtós szekrény
válaszfalal

Kód: 222



Csavarhossz = 35 mm

2x



2x

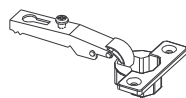

6x



Csavarhossz = 16 mm

12x



6x



8x

3.

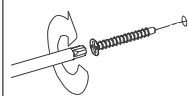
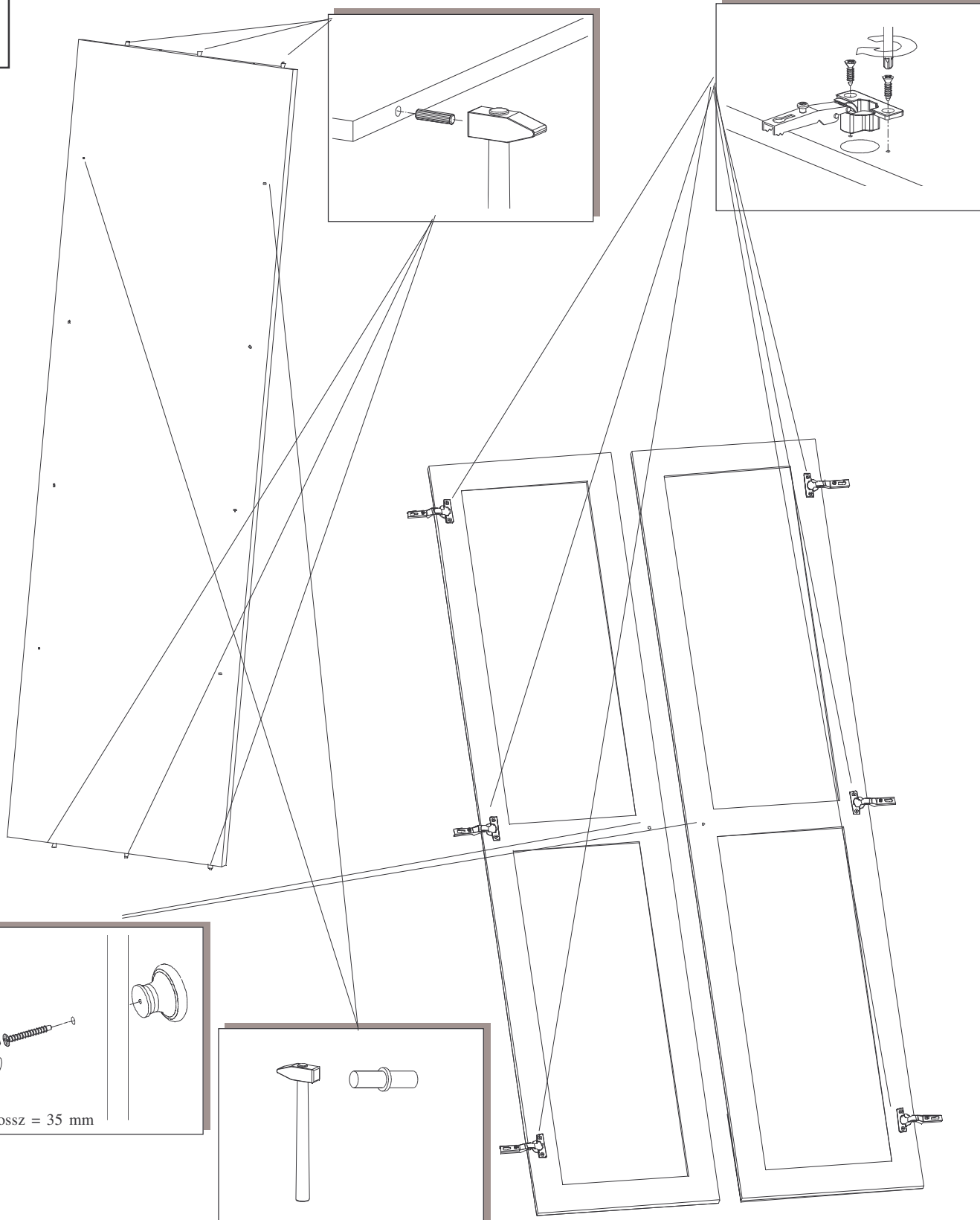

Csavarhossz = 35 mm

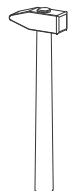

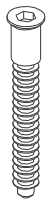

2 ajtós szekrény
válaszfalal

Kód: 222

22x

4.

Figyelem! Először a rudat helyezze be!

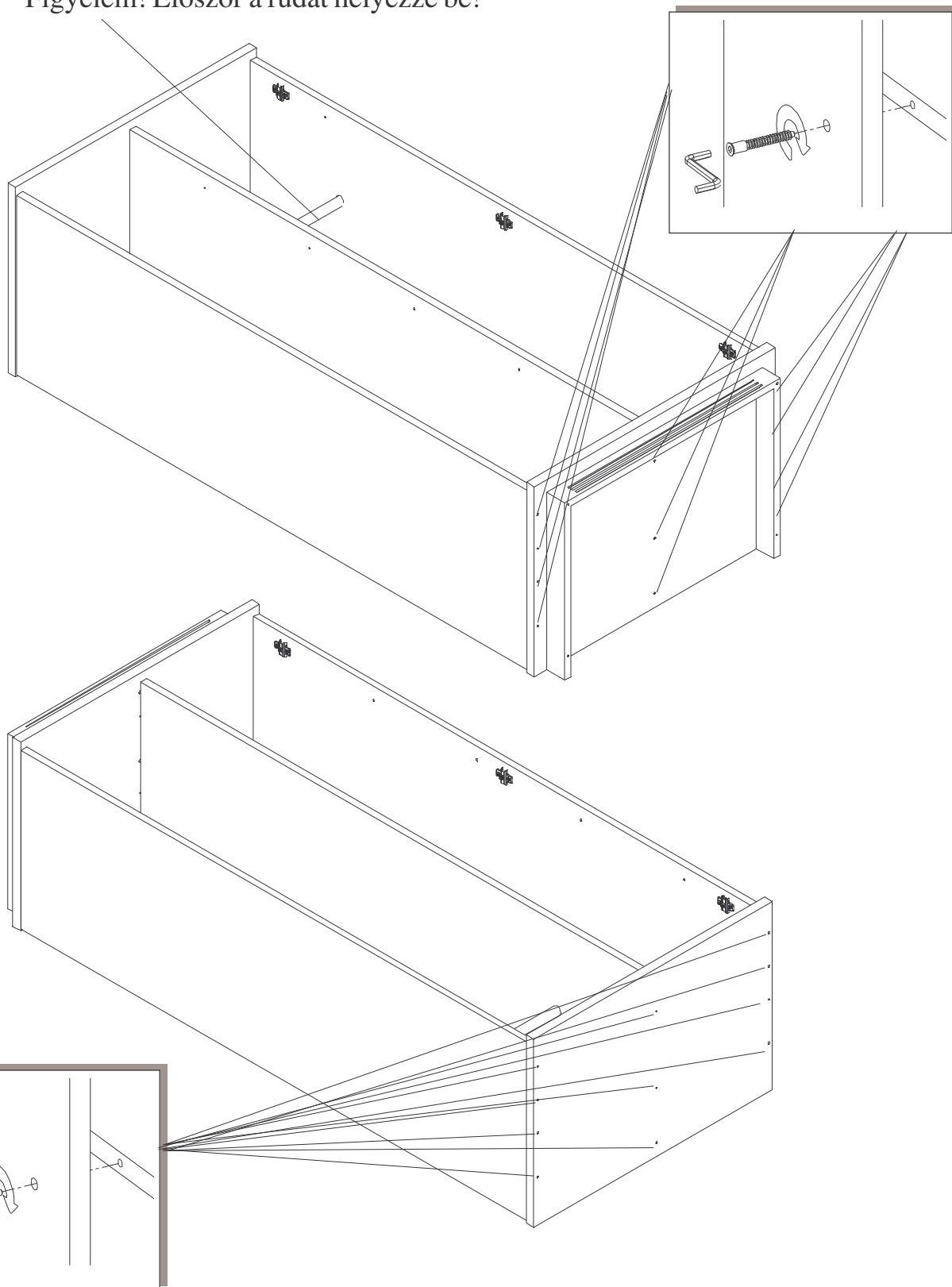



2 ajtós szekrény
válaszfalal

Kód: 222

60x

5.

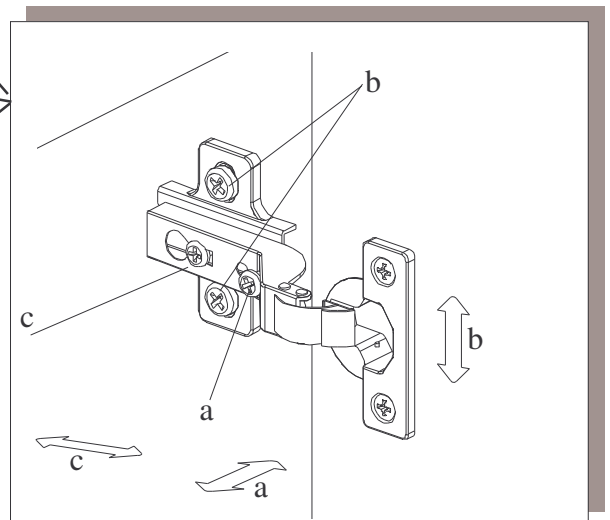
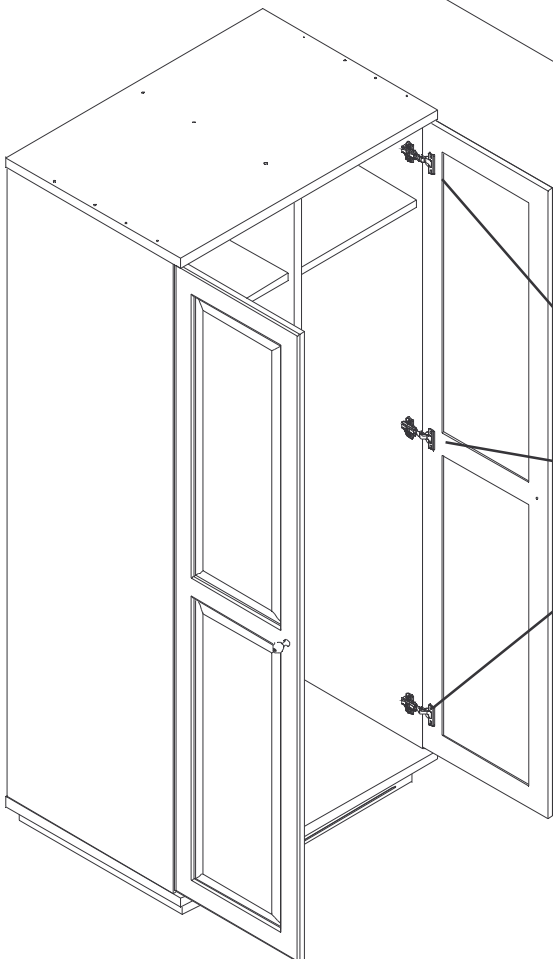
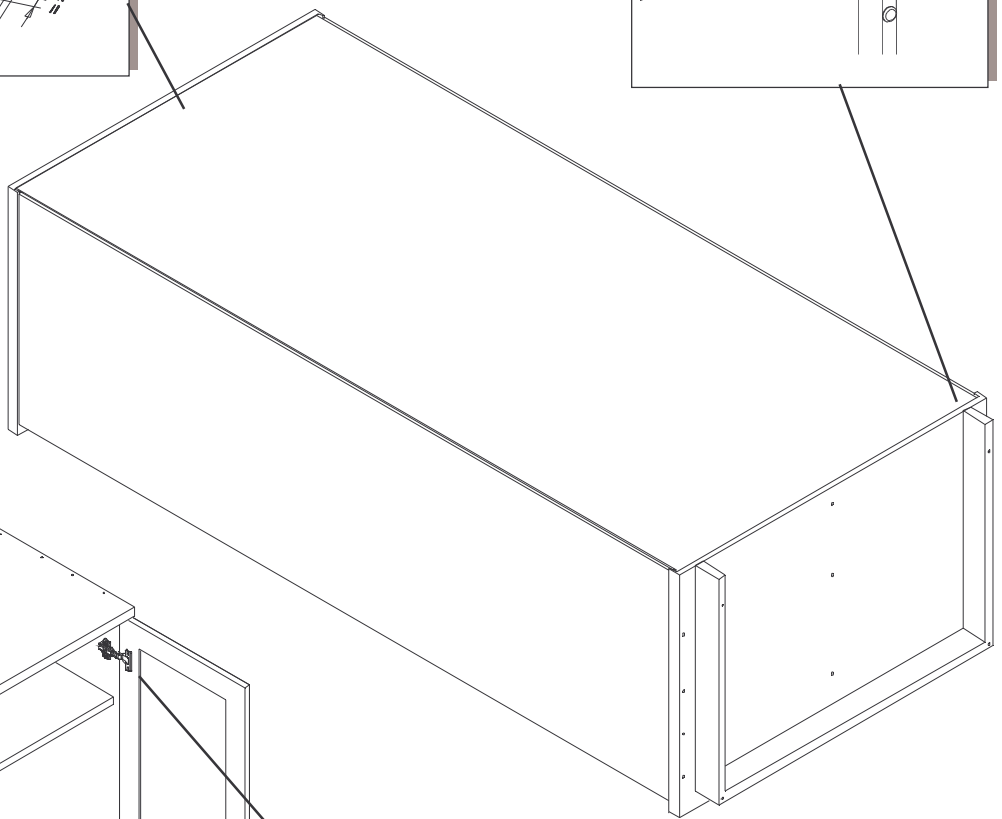
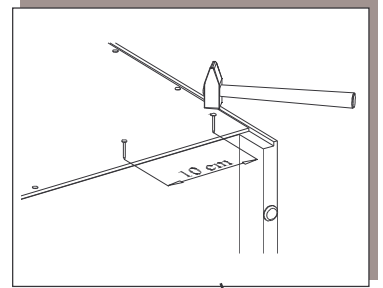
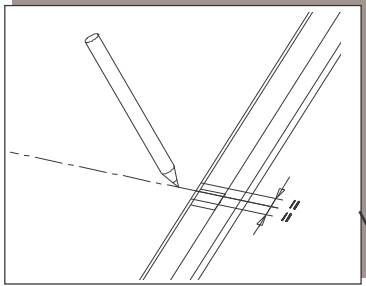

2 ajtós szekrény
válaszfalal

Kód: 222

6.



FONTOS: Őrizze meg a későbbi hivatkozásokhoz,
reklamáció esetén a név melletti sorszámmal tudja
jótállási igényét bejelenteni.