

 6x	 4x		 2 ajtós akasztós szekrény  Kód.: 221
Csavarhossz=13mm  12x	 12x		Súly: 65 kg

1.

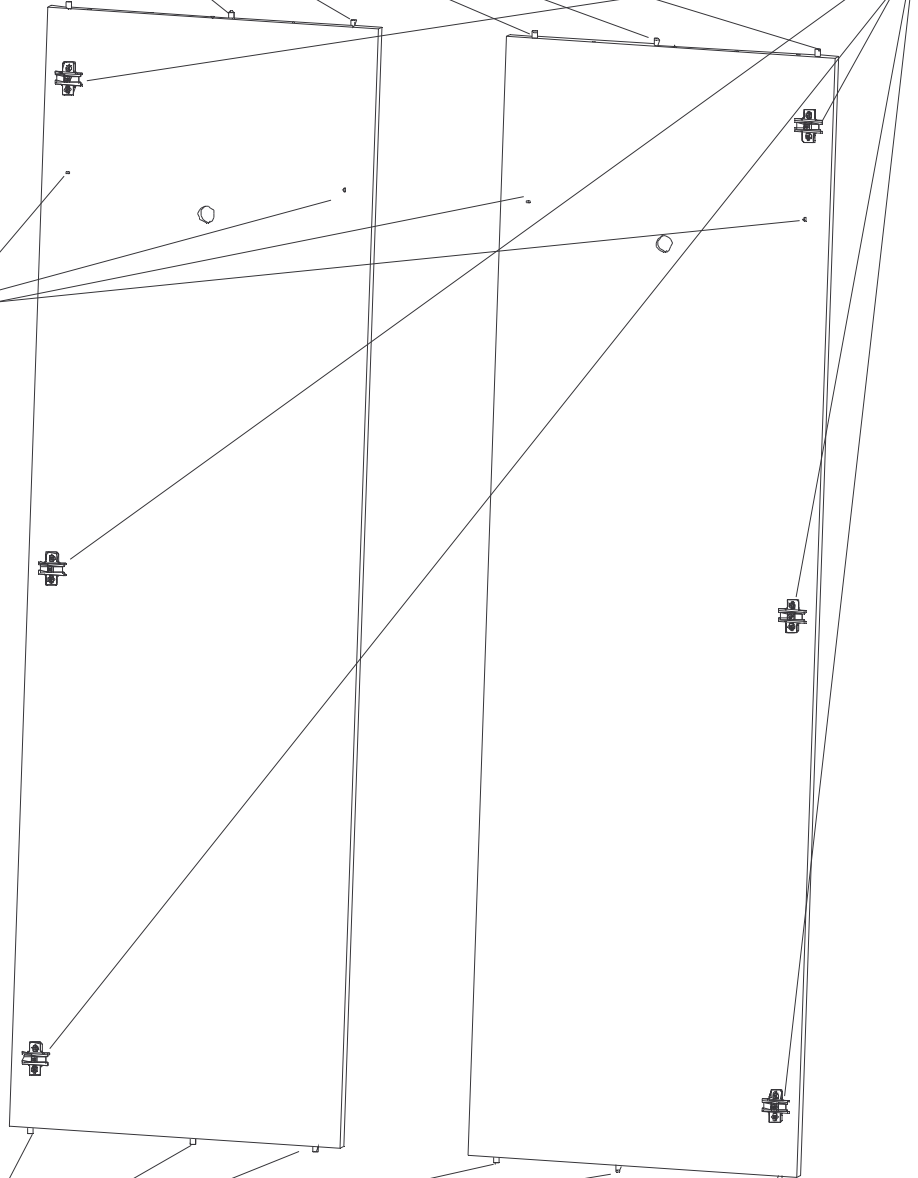

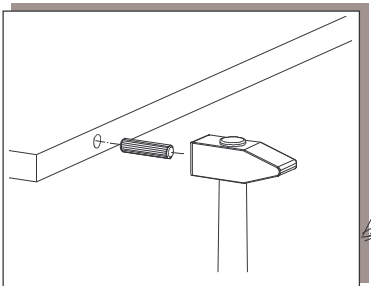
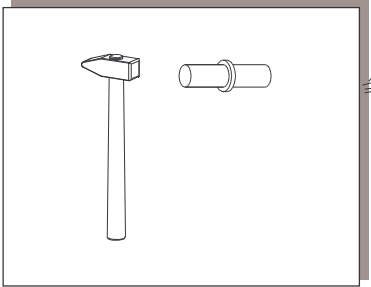
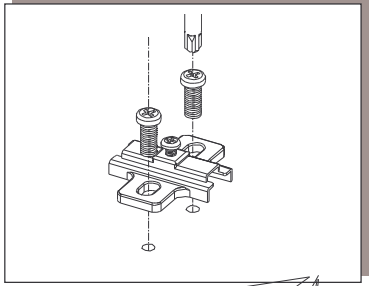
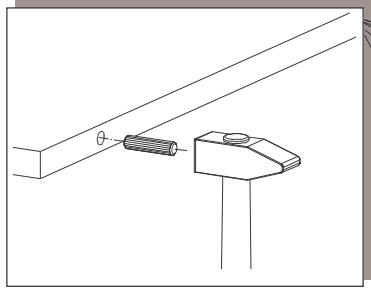
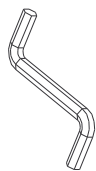

1x

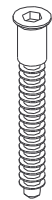

4x

2 ajtós akasztós
szekrény

Kód: 221

2.

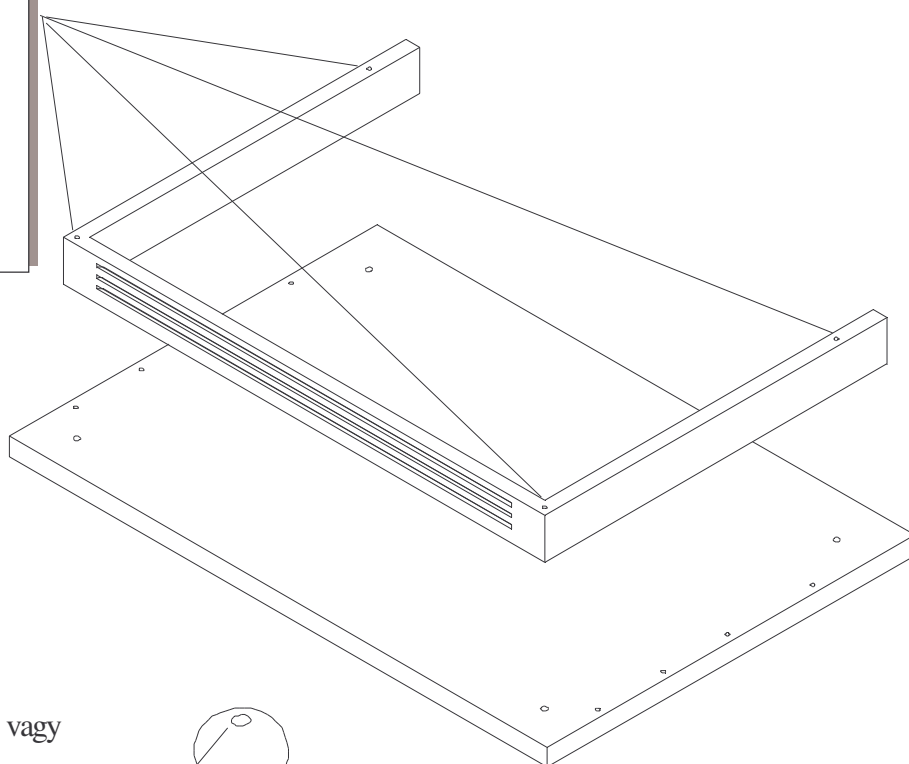
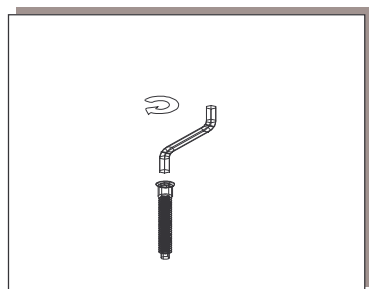

vagy

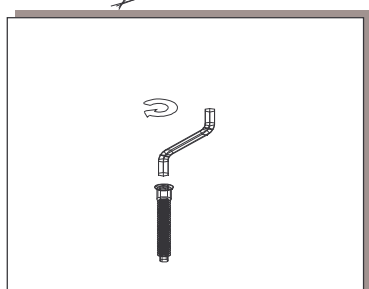
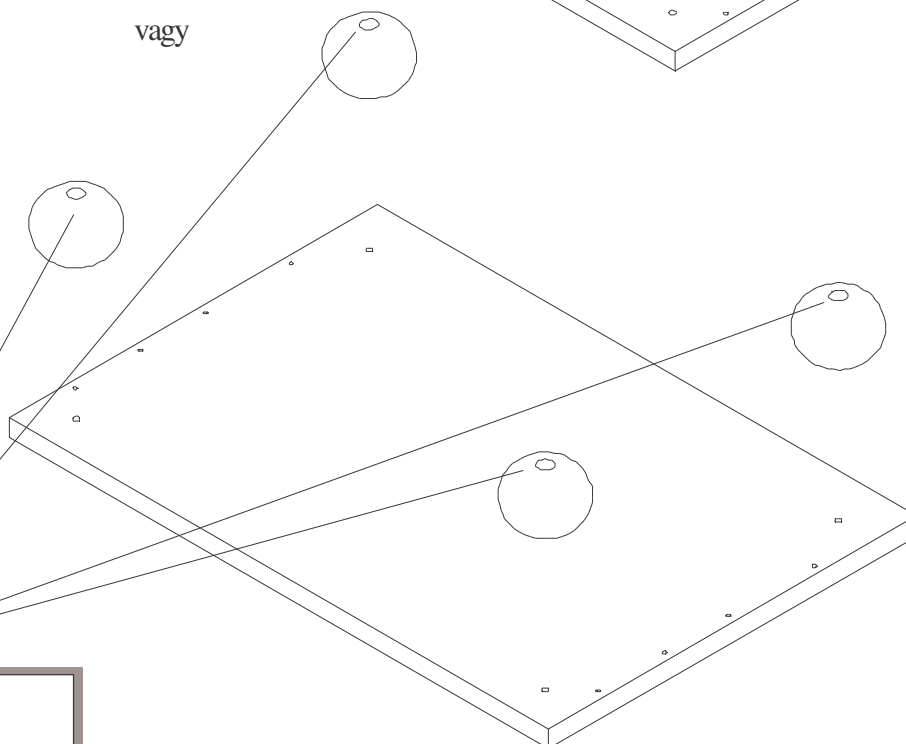

A szekrény lábázatát igénytől függően
szerelvényezheti fel, az ábrán látható két
mód közül.

 <p>Csavarhossz = 35 mm</p> <p>2x</p>	 <p>2x</p>  <p>6x</p>	 <p>Csavarhossz = 16 mm</p> <p>12x</p>		<p>2 ajtós akasztós szekrény</p> <p>Kód: 221</p>
--	---	---	--	--

3.

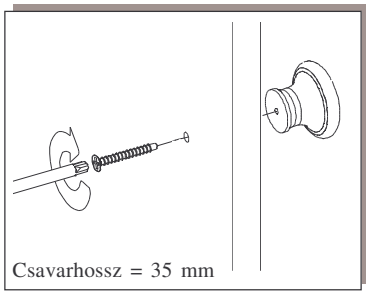
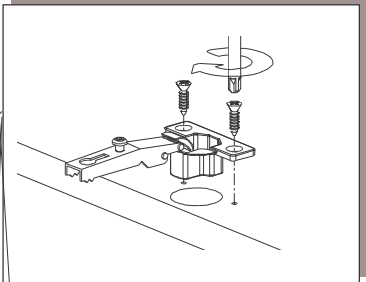
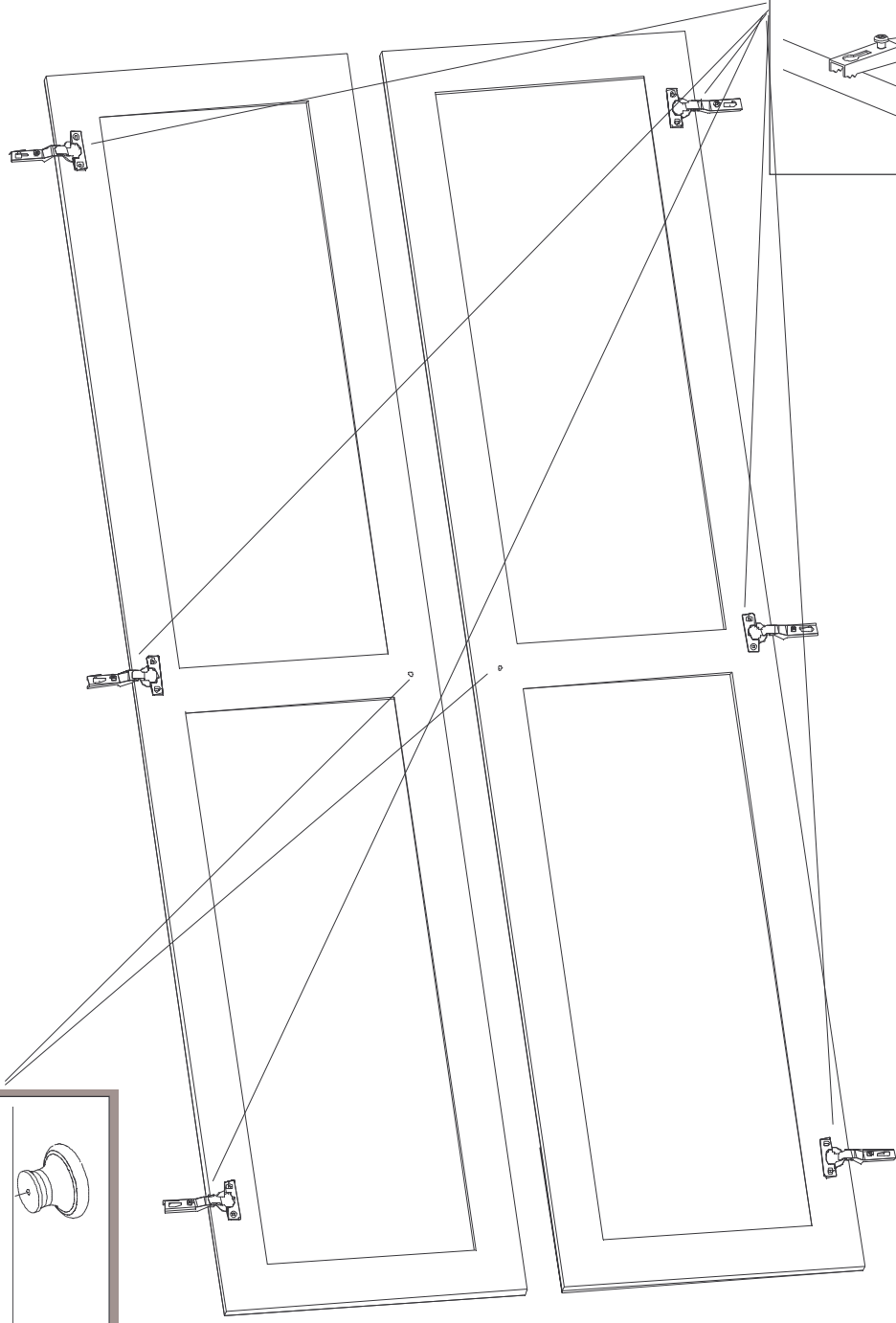

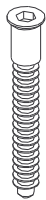

2 ajtós akasztós
szekrény

Kód: 221

16x

4.

Figyelem! Először a rudat helyezze be!

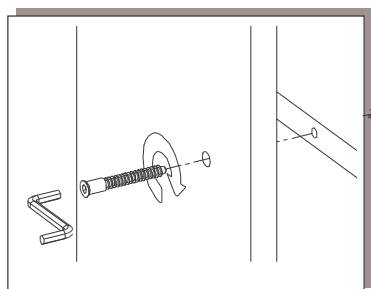
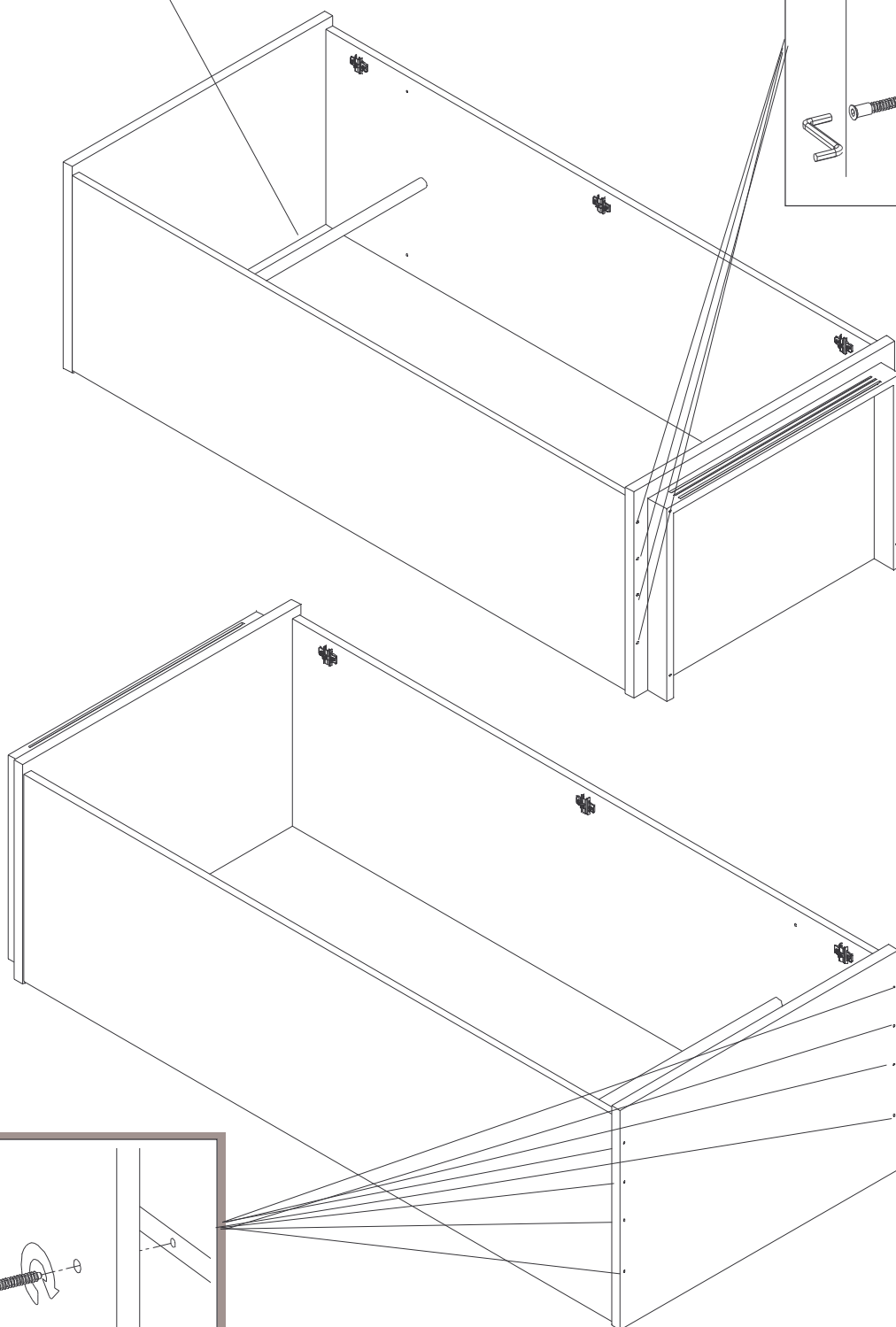



2 ajtós akasztós
szekrény

Kód: 221

60x

5.

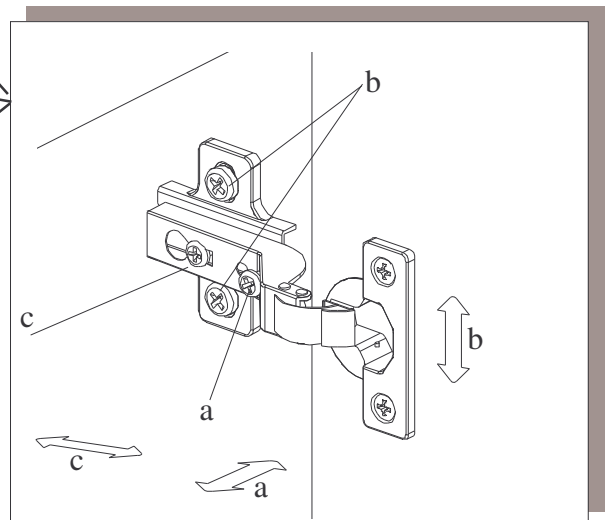
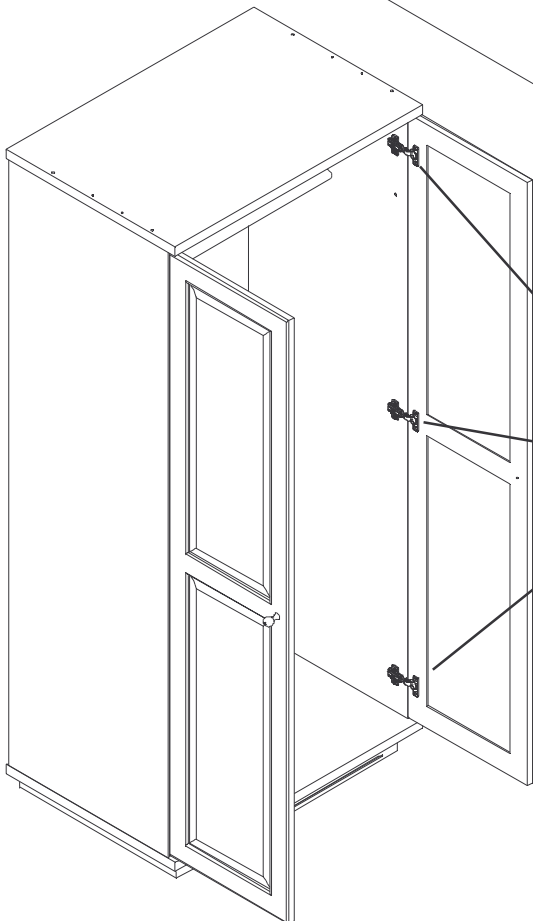
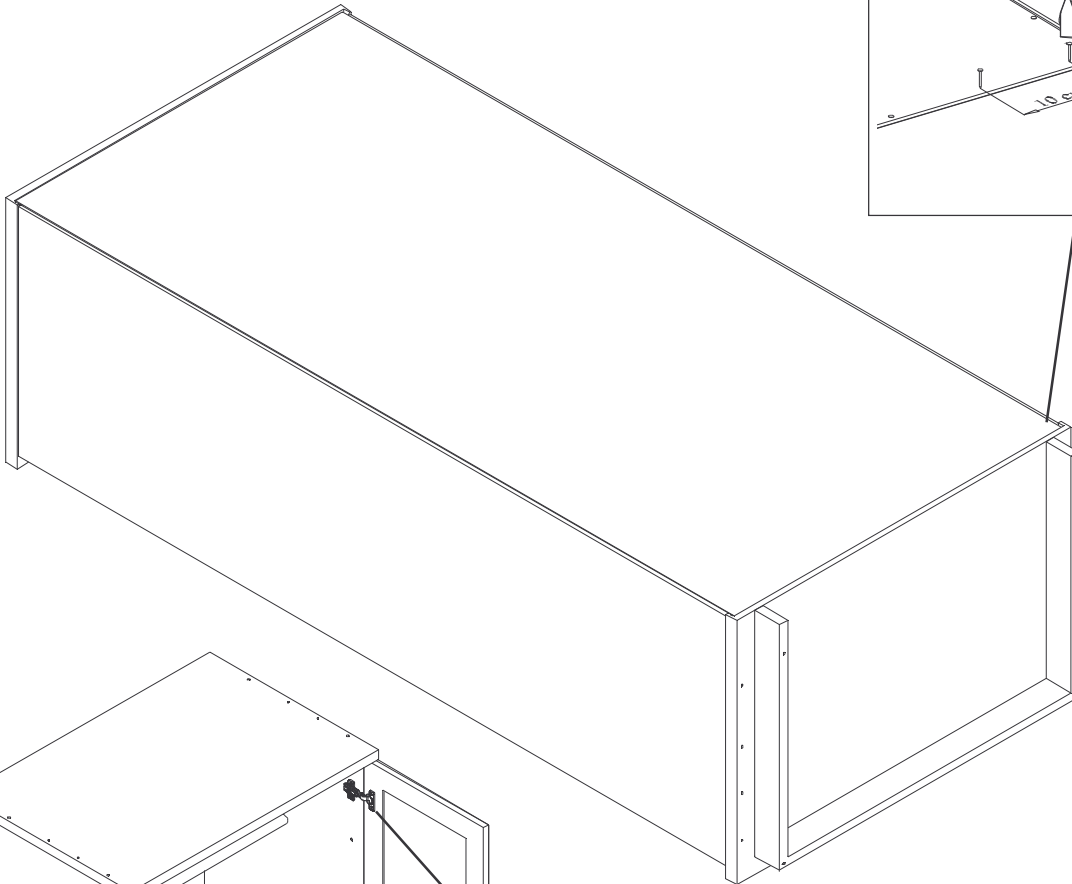

2 ajtós akasztós
szekrény

Kód: 221

6.

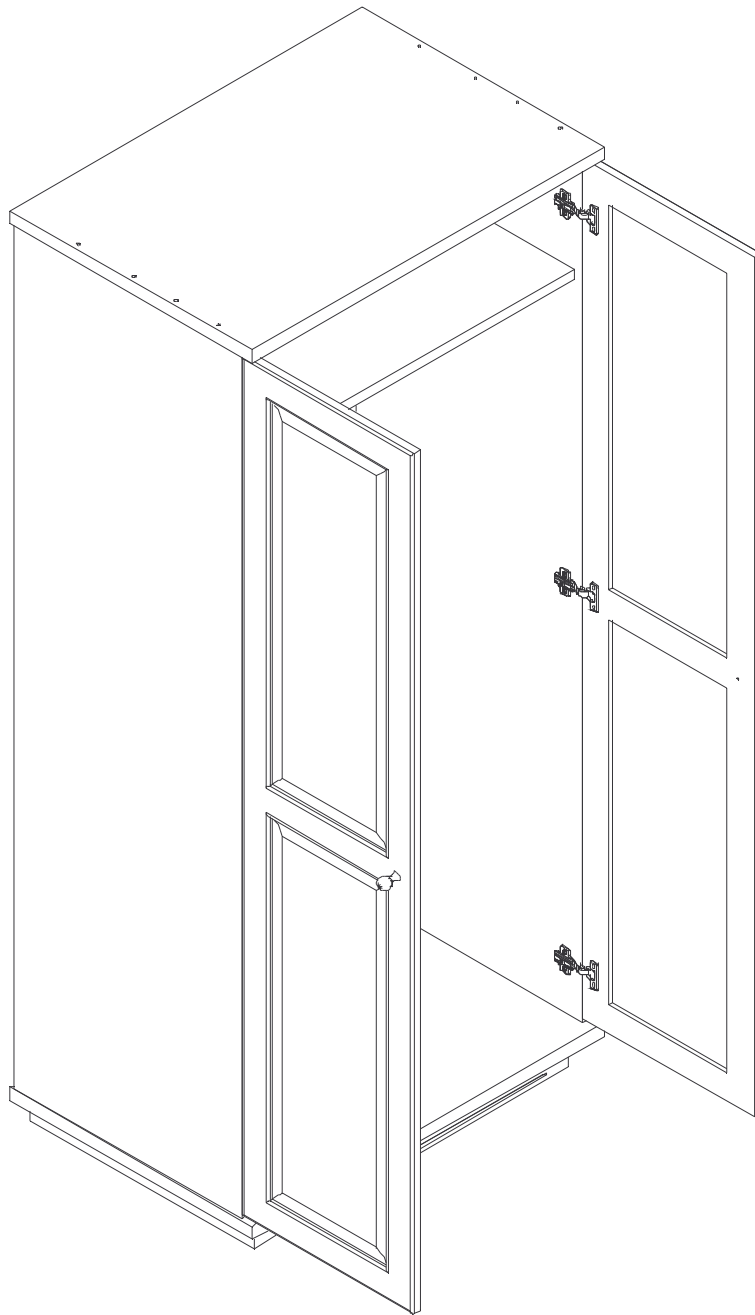

FONTOS: Őrizze meg a későbbi hivatkozásokhoz,
reklamáció esetén a név melletti sorszámmal tudja
jótállási igényét bejelenteni.